

Step by Step Guide – Rainwater Installation Guide

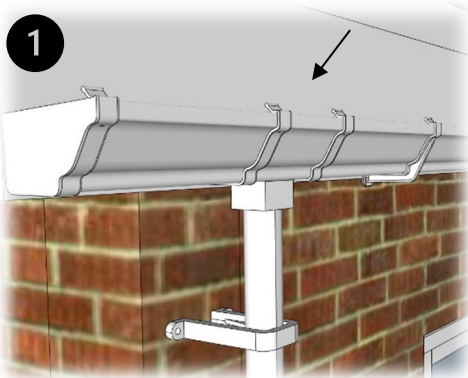

- To ensure the running outlet is positioned accurately, hold a plumb line against the fascia, directly over the gully.
- Mark the running outlet position using a pencil.
- Then fit the outlet no more than 50mm under the roof level.

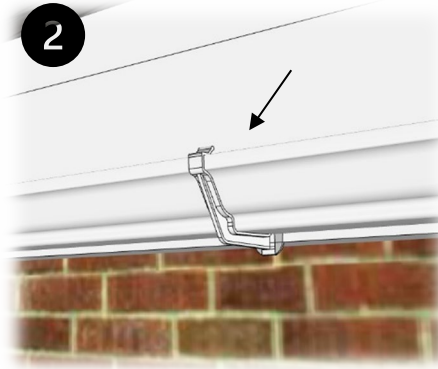

- Fit the fascia bracket at the opposite site of the running outlet, just below the top of the fascia board.

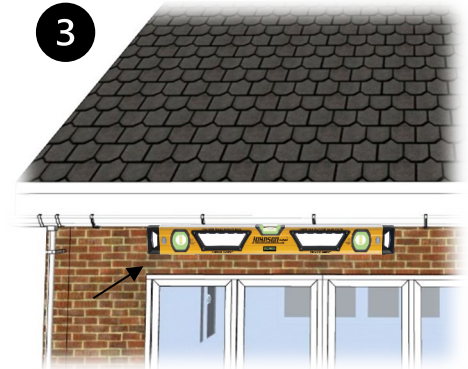

- Use a spirit level to check the fall towards the running outlet.
- The recommended is 1.350.

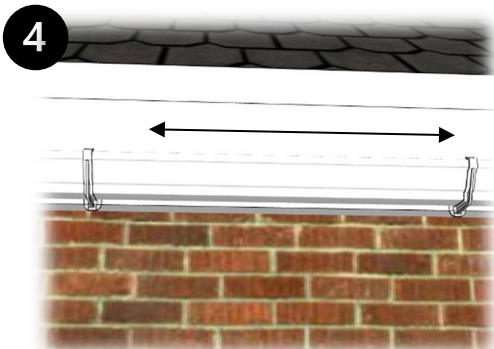

- Mark the precise position of the fascia brackets, keeping them a maximum of 150mm from any angle or stop end and not further than 1000mm apart (400mm in areas with high snowfall).



- Fix all fascia brackets to the fascia board.
- Please use a minimum of 2 screws 25mm x 5mm brass or zinc round head screws for high loading applications please use 3 screws.

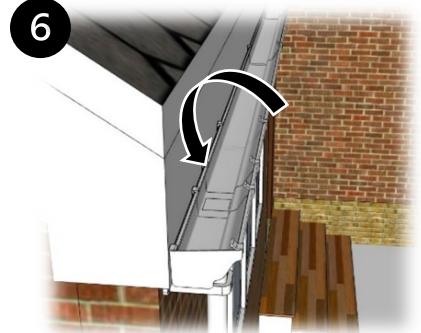

- Using the **back to front** method, start to fit the lengths of the gutter.
- The next length of gutter should be inserted into the union bracket that is fitted at the other end of the first length and screwed into the fascia.
- Keep joining lengths.
- Ensure that every joint aligns with the insertion depth marked on the fittings.

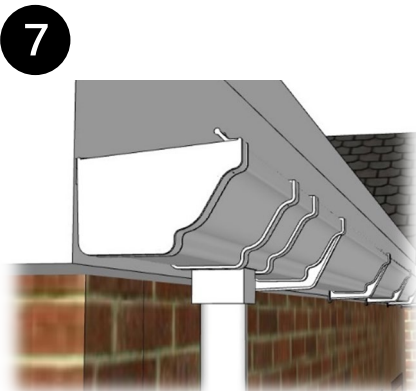

- Fit an external stop end at one or both sides of the gutter.

Remember:

You should only be testing the gutter with the fittings **ONLY** when they are installed. Do not test the system until the job is complete

Step by Step Guide – Rainwater Installation Guide

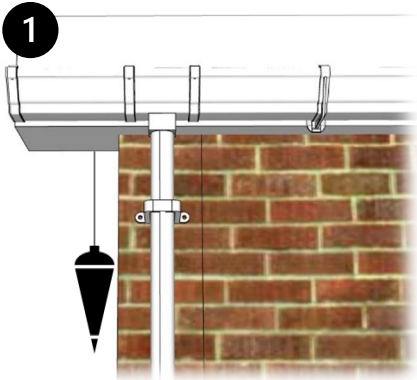

- From the running outlet, mark a vertical line, using a plumb line, from the outlet to the drain.

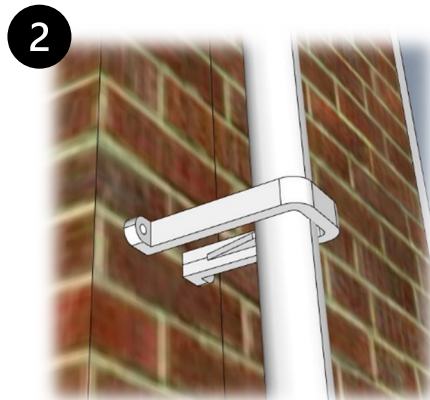

- Mark the fixing holes with a pen, using a downpipe clip. Space the clips no more than 1.8m apart.

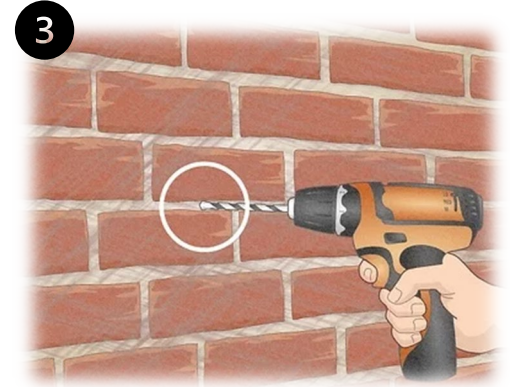

- Drill the holes for the pipe clips.

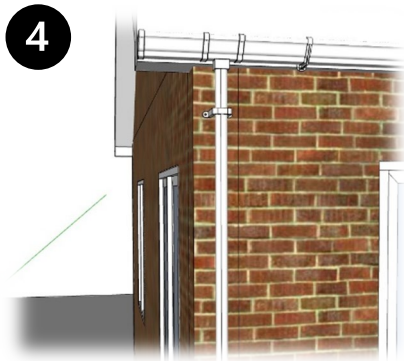

- Install the downpipe, from top to bottom. Fit a pipe clip on top of the joint.
- Leave a 10mm gap between the end of the pipe and the bottom of the pipe socket to allow for expansion.

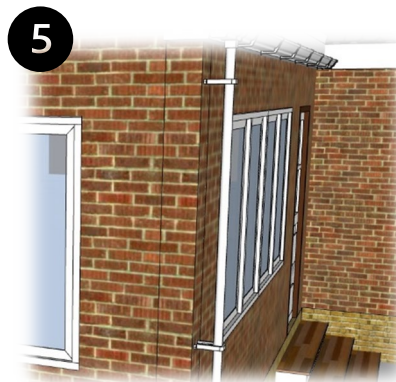

- Fit and screw the pipe clips to the down pipe.

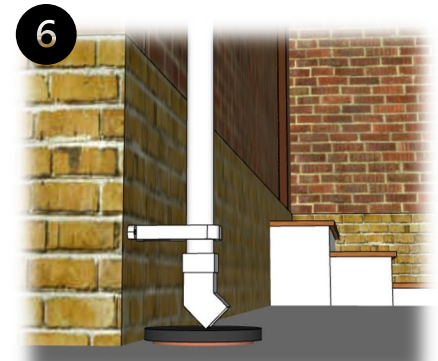

- Fit the shoe at the bottom of the downpipe so that it directs water into the drain, if required.

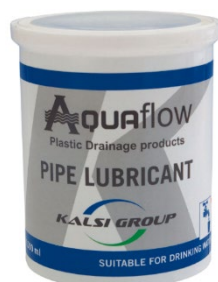

Remember:

Kalsi Plastics' fittings are all pre-lubricated. However we recommend using extra lubricant in case the seals have run dry for easier fit. Lubricant must be used on all shaped and large gutter systems

Step by Step Guide – Shaped Gutters Ogee, Deep Flow Kommercial and Kommercial Xtra



- Please ensure that fascia brackets are fitted at 800mm for Klassic and Krown Ogee systems.

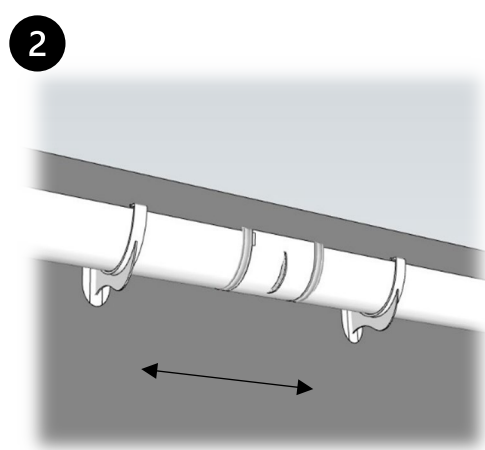
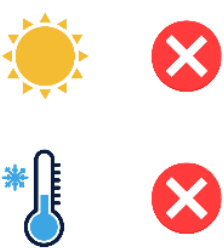

- For Deep Flow Kommercial and Kommercial Xtra, fascia brackets are fitted at 600mm centres.



- Top hung fascia brackets must be fitted at no more than 400mm centres.

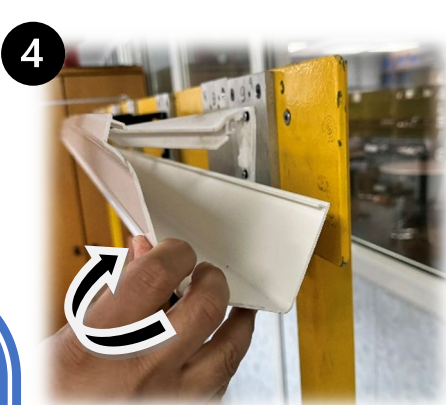

- On top hung fascia brackets, the gutter must be inserted using the **front to back** method, otherwise you could damage the top hung fascia bracket and the gutter.



- For the ease of cleaning, the top hung fascia brackets are designed to be easily dismantled. To do this you simply unclip the top hung fascia bracket by pulling the gutter away from the bracket using the **front to back** method.

Remember:

All Aquaflow rainwater systems must not be stored in direct sunlight, as this can cause distortion and warping, and must not be stored in vans due to excessive heat in the summer. Please ensure all products are stored in the shade and taken out of the protective wrapping to avoid excess heat built-up.

In the winter all products must be stored indoors and away from vans due to extreme temperature movements as this can cause the gutter and fittings to go brittle and results in gutter fascia brackets snapping and gutters shattering when you try to cut them. We recommend that all our rainwater systems should be stored at room temperature for 24 hours before fitting.

Remember:

All gutters must be fitted to gutter insertion point as marked in the fittings. This allows the gutters to expand and contract in summer and winter. If not fitted to the insertion point, this can result in leaks due to the gutter shrinking and making no contact